



ES&S TABULATOR STICKER SPECIFICATION

ELECTION
SYSTEMS & SOFTWARE

ES&S does not recommend the usage of stickers on optically scanned paper ballots.

Placing stickers on optically scanned paper ballots will always have the potential to degrade the performance of the tabulators. Just how much depends on the type of label used, the tabulators involved, the way the labels are applied, and the number of voters that actually use them.

For instance, if a number of voters use the label in the same location on their ballots, it will result in an accumulative affect on a stack of ballots. This uneven stack of ballots could have a negative effect on a central ballot tabulator's ballot feeding mechanism, and on its output stacking.

The geometry of the read heads on all optical scan tabulators are optimized for ballot control and sensitivity, so loosely adhered labels or labels that are very thick can cause jams in the read head stage of the tabulators. Depending on how the label is placed, the potential for read irregularities or scanning errors exists.

Despite the consequences involved, stickers have been used successfully in the past, and are not uncommon. But to minimize any potential problems or disruptions, ES&S has published the following guidelines.

Optical scan ballots have strict paper and printing specifications to ensure the ballots are scanned efficiently and accurately. Stickers placed on these important documents are no different in this regard. Label thickness, size, and adhesive properties are very important factors that need to be controlled to ensure proper operation of your optical scan ballot tabulators.

Basic Label Requirements:

- Label Thickness – The label material shall not be thicker than .005". For reference purposes, the ballot itself is .006" thick.
- Label Width – The length of a write-in label should not exceed 1.75".
- Label Height – The height of a response target row on an ES&S ballot is .333". In order to keep the label within the confines of a single row, the label should be only .3" high. Taller labels can be used with the understanding it could cover ballot information above or below the write-in space.
- Label Corners – The corners of the label should be rounded to help prevent peeling.
- Label Adhesive – We do not offer a specific adhesive specification, only that the adhesive properties are strong enough to prevent a label from being easily dislodged from the ballot during scanning. This could result in a scanner malfunction. As a general rule, the sticker must adhere strongly enough to the ballot that a fingernail or other sharp device would be needed to peel back a corner of the label. Rounded corners on the label will help in this regard.
- Label Placement - It is important that these labels are placed to the side of the oval response area, directly over the position reserved for write-ins. If this label is placed anywhere else on the ballot, there is a risk that the ballot could be rejected with a ballot scanning error.

If you are uncertain as to whether the stickers adhere to these specifications, we recommend that when samples become available they be sent to ES&S for evaluation.

REVISIONS				
REV	DESCRIPTION	ECO	DATE	BY
A	INITIAL RELEASE		3/7/08	WDM BT

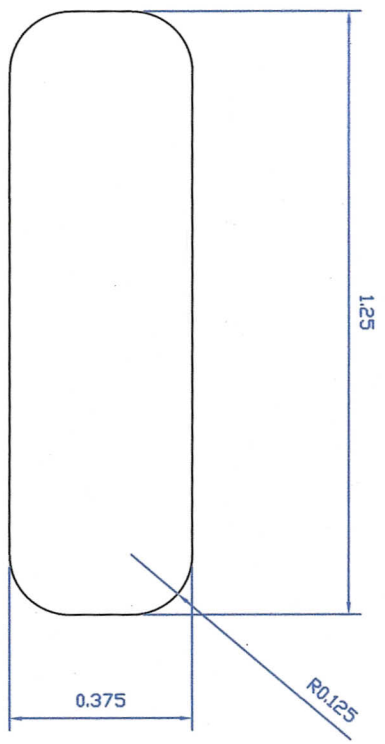

NOTES:
 MATERIAL: OPAQUE WHITE MATTE LASER LABEL
 ADHESIVE: PERMANENT
 THESE WILL COME ON A 54lb. FACE ON A 60lb. 8 1/2 X 11" LINER. 120 LABELS PER SHEET.

PROPRIETARY AND CONFIDENTIAL THE INFORMATION CONTAINED IN THIS DRAWING IS THE SOLE PROPERTY OF ELECTION SYSTEMS & SOFTWARE. ANY REPRODUCTION IN PART OR AS A WHOLE WITHOUT WRITTEN PERMISSION OF ELECTION SYSTEMS & SOFTWARE IS PROHIBITED.		UNLESS OTHERWISE SPECIFIED TOLERANCES ARE: .XX ± .01 .XXX ± .005 ANG ± 1/32 FAC ± 1/32 SEE PARTS LIST	CODE QTY PART NUMBER	DESCRIPTION PARTS LIST ELECTION SYSTEMS AND SOFTWARE 100/650 LABEL	SPECIFICATION
NEXT ASSY / USED ON APPLICATION	QTY	FINISH	APPROVALS DWM WDM DATE 3/7/08	SCALE NONE	REV. A
DO NOT SCALE DRAWING		DIMC. NO. XXXXX	SHEET 1 OF 1		